

# 开关元件

## DIP微小按键开关

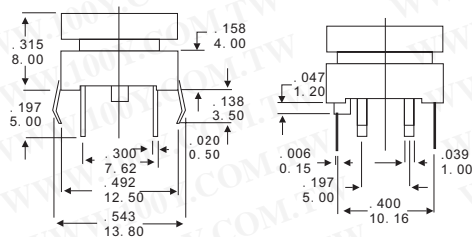
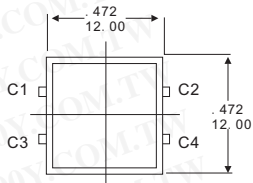

详细产品规格 - 请点击 [cn.100y.com.tw](http://cn.100y.com.tw)

规格:

接点安排	S.P.S.T
四周湿度	85%RH max.
接点阻抗	100mΩ max. initial
绝缘电阻	100MΩ max.
承受电压强度:	250VAC, 1 minl
操作温度:	10°C to 60°C
操作能力:	250gf max.
操作寿命:	300,000 cycles min.
故障耐久性:	10 to 55 Hz 0.75mm double amplitude during 2 hrs
总周期:	0.3mm ± 0.1mm
LED等级:	50mA / 12VDC Voltage 6V max. current 20mA max.

100Y 编号	厂商编号	说明	Pins	Type	Contact Rating
18102	YLP12-GC02	Illuminated Tact Switches	6P	12*12mm 方框 绿面 绿 LED	12Vdc/50mA
18104	YLP12-RC02	Illuminated Tact Switches	6P	12*12mm 方框 红面 红 LED	12Vdc/50mA
18103	YLP12-YC02	Illuminated Tact Switches	6P	12*12mm 方框 黄面 黄 LED	12Vdc/50mA



YLP13-A-5-A-532

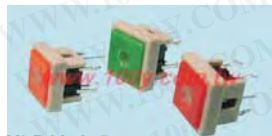

YLP13-A-5



YLP13-B-5

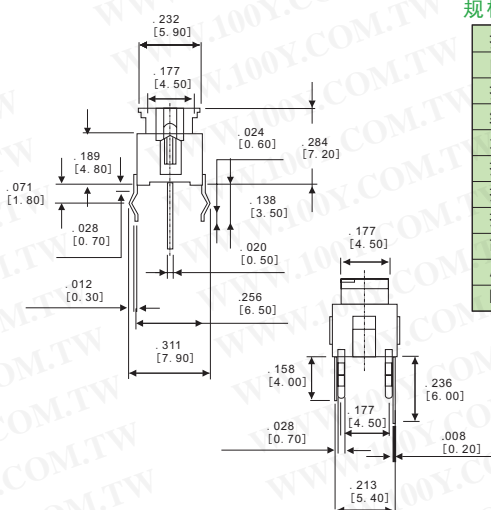

规格:

接点安排	S.P.S.T
四周湿度	85%RH max.
接点阻抗	100mΩ max. initial
绝缘电阻	100MΩ max.
承受电压强度:	250VAC, 1 minl
操作温度:	10°C to 60°C
操作能力:	250gf max.
操作寿命:	300,000 cycles min.
故障耐久性:	10 to 55 Hz 0.75mm double amplitude during 2 hrs
总周期:	0.3mm ± 0.1mm
LED等级:	50mA / 12VDC Voltage 6V max. current 20mA max.

机架	Nylon6/6 +15% gf
盖子	PC
可移动刀片	PBS + AG
LED Stem:	PBS+PC+LED
端子:	黄铜
上部基地:	PC

100Y 编号	厂商编号	说明	Pins	Type	Contact Rating
18094	YLP13-A-5-A-532	Illuminated Tact Switches	4P	10*10mm 灰方框灰面	12Vdc/50mA
18095	YLP13-A-5-B1-132	Illuminated Tact Switches	6P	10*10mm 灰方框红面 红 LED	12Vdc/50mA
18096	YLP13-A-5-B2-232	Illuminated Tact Switches	6P	10*10mm 灰方框绿面 绿 LED	12Vdc/50mA
18097	YLP13-A-5-B3-332	Illuminated Tact Switches	6P	10*10mm 灰方框橘面 橘 LED	12Vdc/50mA
18098	YLP13-B-5-C-532	Illuminated Tact Switches	4P	10*10mm 灰圆框灰面	12Vdc/50mA
18100	YLP13-B-5-D1-132	Illuminated Tact Switches	6P	10*10mm 灰圆框红面 红 LED	12Vdc/50mA
18099	YLP13-B-5-D2-232	Illuminated Tact Switches	6P	10*10mm 灰圆框绿面 绿 LED	12Vdc/50mA
18101	YLP13-B-5-D3-332	Illuminated Tact Switches	6P	10*10mm 灰圆框橘面 橘 LED	12Vdc/50mA

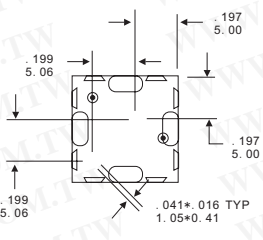
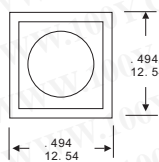
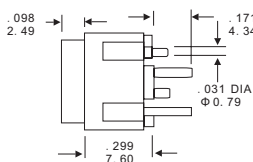

规格:

- 接点规定值: 250Ma max. @ 50V AC or DC max.
- 机械寿命: 50,000 actuations.
- 接点阻抗: 20 milliohms max.
- 绝缘阻抗: 100 milliohms max.
- 电介质强度: 1,000V RMS min. @ sea level.
- 操作温度: -30°C TO 60°C

材料:

- CASE: 玻璃被填充的尼龙
- ACTUATOR: ABS
- 滑动触头: 镀铜, 镀银
- 机架: 不锈钢
- 固定式触头 & 终端: 铜合金 镀银.

100Y 编号	厂商编号	说明	Pins	Type	Contact Rating	Button Color
7911	YR18-801-1C05	白色开关	2	OFF-MOM	25mA msx. @50V AC or DC max.	
10613	YR18-801-2	黑色开关 2P	2	OFF-MOM	25mA msx. @50V AC or DC max.	
7913	YR18-801-3C05	红色开关	2	OFF-MOM	25mA msx. @50V AC or DC max.	
7912	YR18-801-5C05	黄色开关	2	OFF-MOM	25mA msx. @50V AC or DC max.	
2198	YR18-801-6	绿色开关	2	OFF-MOM	25mA msx. @50V AC or DC max.	
8539	YR18-801-7C05	蓝色开关	2Pins	OFF-MOM	25mA msx. @50V AC or DC max.	
37540	YR18-801-9C05	灰色开关	2Pins	OFF-MOM	25mA msx. @50V AC or DC max.	灰



服务专线: 台湾: 886-3-5753170  
 传 真: 台湾: 886-3-5753172  
 E-mail: 台湾: sale@100y.com.tw

深圳: 86-755-83298787  
 深圳: 86-755-83640655  
 深圳: 100y@163.com

上海: 86-21-34970699  
 上海: 86-21-64605107  
 上海: 100y-1@163.com