

# 电源供应器+转换器+UPS

## MOTIEN\_直流转直流- 单组电源转换器

详细产品规格 - 请点击 [cn.100y.com.tw](http://cn.100y.com.tw)



- 8 Pin SIL // 16 Pin DIL 包裹
- Wide 2:1 Input Range
- Full SMD Technology
- 1000 Vdc Isolation
- Up to 3000 Vdc Isolation
- 短路保护连续
- 电信仪器
- 过程/机器控制设备

### 输出规格

电压准确性:  $\pm 2\%$

波纹 & 噪声 (20 Mhz band width): 80mV pk-pk

### 物理规格

重量: 4.5g (SIP) ~6g (DIP)

直径: SIP Case 0.86" x 0.36" x 0.44"

DIP Case 0.92" x 0.40" x 0.55"

### 一般规格

安全标准: IEC 60950-1:2001

### 环境规格

运行的温度:  $-40^{\circ}\text{C} \sim 85^{\circ}\text{C}$

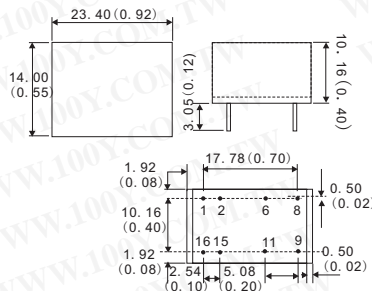
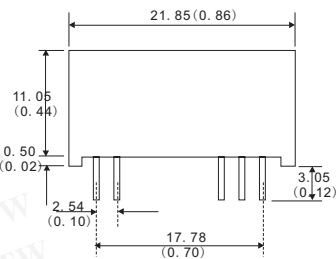

16 PIN DIL Package

Pin number	Single
1	-V Input
2	-V Input
6	N. C.
8	N. C.
9	+V output
11	-V output
15	+V Input
16	+V Input

Pin number	Single
1	-V Input
2	+V Input
6	+V output
7	-V output
8	N. C.

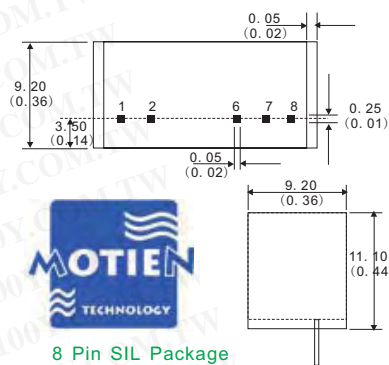

8 Pin SIL Package

100Y 编号	厂商编号	制造厂商	说明	DCVout	Current	Watts	Efficiency %	DCVin
39888	VB-0505S2	MOTIEN	DC/DC 单组电源转换器(=TRACO_TMR 0511)	400mA	5.0V	2W	66%	4.5-9V
39906	VB-0512S2C	MOTIEN	DC/DC 单组电源转换器(=TRACO_TMR 0512)	12.0V	167mA	2W	70%	4.5-9V
39908	VB-1212S2	MOTIEN	DC/DC 单组电源转换器(=TRACO_TMR 1211)	12.0V	167mA	2W	77%	9-18V
39909	VB-2424S2	MOTIEN	DC/DC 单组电源转换器(=TRACO_TMR 2411)	24V	83mA	2W	77%	18-36V



### 3W series

- Wide 2:1 Input Range
- Full SMD Technology
- 1500 Vdc Isolation up to 3500 Vdc Isolation
- 短路保护连续
- 低侧面金属包裹
- 数据通信设备
- 过程/机器控制设备
- Meet UL/cUL approval

### 输出规格

电压准确性:  $\pm 1\%$

波纹 & 噪声 (20 Mhz band width): 60mV pk-pk

### 物理规格

重量: 17.0g

直径: 1.28" x 0.84" x 0.41"

1.25" x 0.8" x 0.4" (plastic case)

### 一般规格

安全标准: IEC 60950-1:2001

### 环境规格

运行的温度:  $-40^{\circ}\text{C} \sim 85^{\circ}\text{C}$

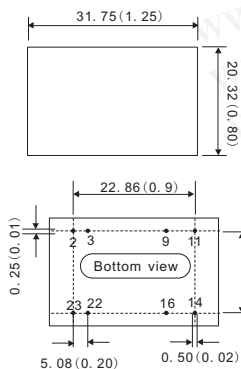
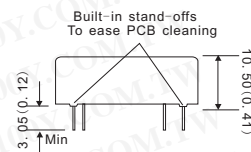

Pin number	Single	Dual
2	-V Input	-V Input
3	-V Input	-V Input
9	N. P.	Common
11	N. C.	-V output
14	+V output	+V output
16	-V output	Common
22	+V Input	+V Input
23	+V Input	+V Input

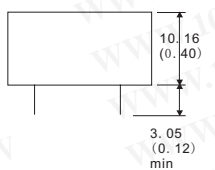

For "P" case

24 Pin DIL package  
Non-conductive plastic

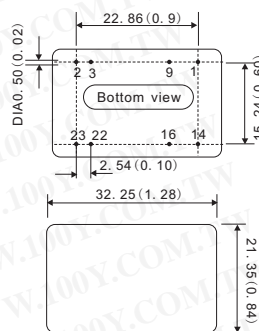

Pin number	Single	Dual
2	-V Input	-V Input
3	-V Input	-V Input
9	N. P.	Common
11	N. C.	-V output
14	+V output	+V output
16	-V output	Common
22	+V Input	+V Input
23	+V Input	+V Input

24 Pin DIL package  
Nickel-coated copper



100Y 编号	厂商编号	制造厂商	说明	DCVout	Current	Watts	Efficiency %	DCVin
39797	VD-1205S3P	MOTIEN	DC/DC 单组电源转换器(=TRACO_TEN3-1211)	5.0V	600mA	3W	76%	9-18V
39772	VD-1205S5	MOTIEN	DC/DC 单组电源转换器(=TRACO_TEN5-1211)	5.0V	1000mA	5W	77%	9-18V
39798	VD-1212S3P	MOTIEN	DC/DC 单组电源转换器(=TRACO_TEN3-1212)	12V	250mA	3W	80%	9-18V
39773	VD-1212S6	MOTIEN	DC/DC 单组电源转换器(=TRACO_TEN5-1212)	12Vdc	500mA	6W	81%	9-18V
39771	VD-123R3S4	MOTIEN	DC/DC 单组电源转换器(=TRACO_TEN5-1210)	3.3Vdc	1200mA	4W	72%	9-18V
39799	VD-2405S3P	MOTIEN	DC/DC 单组电源转换器(=TRACO_TEN3-2411)	5.0V	600mA	3W	76%	18-36V
39774	VD-2405S5	MOTIEN	DC/DC 单组电源转换器(=TRACO_TEN5-2411)	5.0V	1000mA	5W	80%	18-36V
39800	VD-2412S3P	MOTIEN	DC/DC 单组电源转换器(=TRACO_TEN3-2412)	12.0V	250mA	3W	80%	18-36V
39775	VD-2412S6	MOTIEN	DC/DC 单组电源转换器(=TRACO_TEN5-2412)	12V	500mA	6W	80%	18-36V
39776	VD-2415S6	MOTIEN	DC/DC 单组电源转换器(=TRACO_TEN5-2413)	15.0V	400mA	6W	80%	18-36V



服务专线: 台湾: 886-3-5753170

传 真: 台湾: 886-3-5753172

E-mail: 台湾: sale@100y.com.tw

深圳: 86-755-83298787

深圳: 86-755-83640655

深圳: 100y@163.com

上海: 86-21-34970699

上海: 86-21-64605107

上海: 100y-1@163.com